

RCT-35 BM

Hose Retriever for PCAir Systems

ATES RCT-35BM PCAir Hose Retriever is designed to handle up to 35 m of flat insulated hose to reach all the aircraft, including the MD80, preconditioned air connection. The Retriever, equipped with a radio control on the aircraft adapter, needs only one person to be operated. Frame and panels are in zinc coated steel, painted in end user's colour. Maintenance operations can be easily performed. The Retriever is light-weight, protects the hose against eventual damages and from the inclemency of the weather.

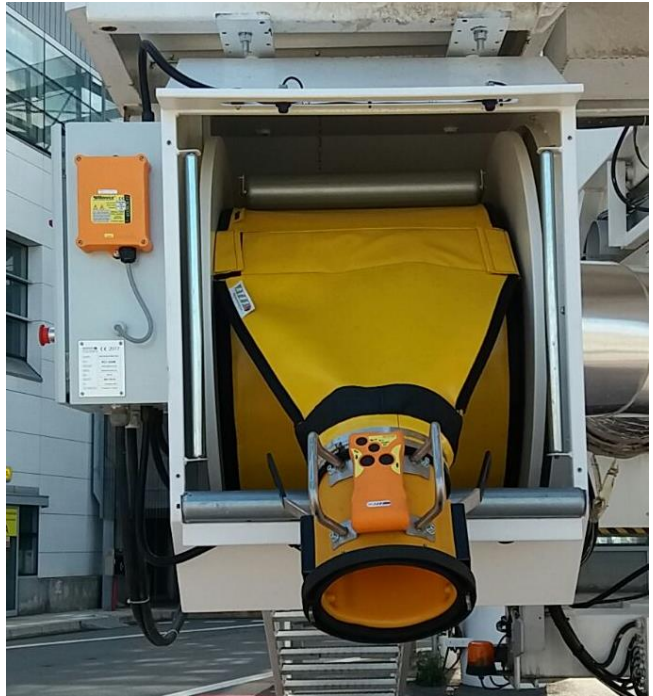

Standard features:

- Zinc coated steel panels, painted in end user's colour
- Inlet air duct elbow angle adjustable .
- Rotating drum with special designed surfaces to reduce air pressure drop (approx. 500 Pa)
- Twin limit switch: "hose all out" proximity switch allowing the correct alignment of the drum; "hose all in" photocells sensing the 14" to 8" reduction of the hose
- Roller with counterweight to keep hose well stored on the drum
- Interlocks with bridge movement (enabled only when the hose is all in) and PCAir start (enabled only when the hose is all out)

UNDER BRIDGE INSTALLATION (LEFT/RIGHT)



Left/Right configuration, installation under passenger boarding bridge

RCT-35 Specifications

Model RCT-35BM
Bridge Mounted

Model RCT-35GM
Ground Mounted

Input power:	3x400V, 50 Hz, 2A circuit breaker Other inputs available on request
Gear motor:	1500 rpm isolation class F, 0.55 kW
Power transmission:	Variable frequency drive
Electrical panel:	IP55 minimum
Hose storage drum:	Zinc coated steel
Frame and canopy	Zinc coated steel, finish in end user's colour
PCAir Hose:	ATES Flat 14" insulated or on customer request
Aircraft coupler:	J&B Type 8" male or equivalent
Mobile control station:	Radiocontrol system (sender, receiver and antenna)
Fixed control station (option):	Integrated with PCAir control station or separate on customer specification

Certification: CE Machine Directory 2006/42/EC

Dimensions: length 722 mm (without gear motor and inlet elbow), depth 1070 mm,
height 1070 mm height 1220 mm
Weight: 170 kg 200 kg (without ground stand)

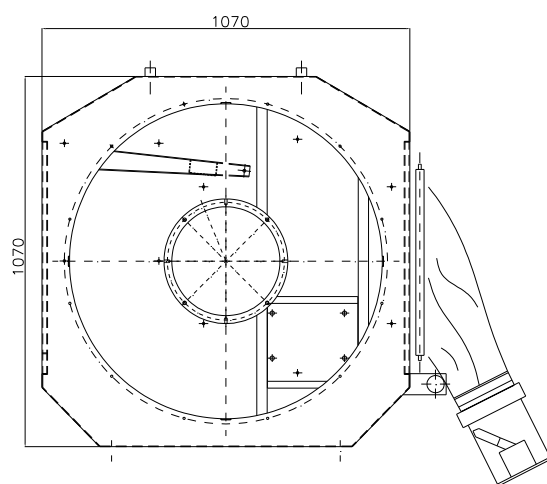
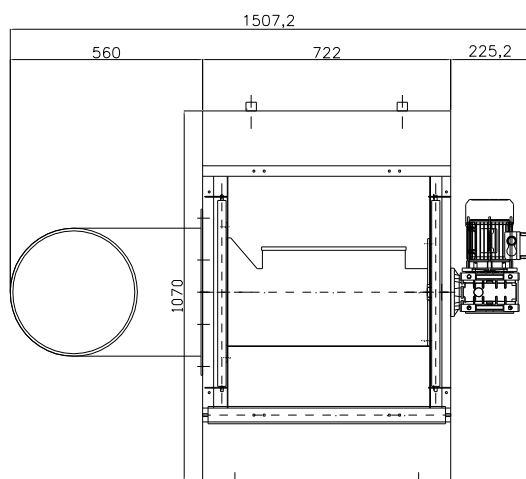

A.T.E.S. ITALIANA S.R.L.

P.LE DE AGOSTINI, 3 - 20146 MILANO, ITALY PH. ++39 02473371,
WEB SITE: WWW.ATESITALIANA.COM E-MAIL: ATES@ATESITALIANA.COM